

Wendeplatten-Falzmesserkopf in Leichtmetall

Cutterblock with tungsten carbide turnover-knives

Porte-outils à feuillure et à dresser à plaquettes réversibles au carbure

Placas reversibles para portachillas ranuradoras en metal ligero



Abmessung Dimension Medidas D Ø x B x d Ø mm	Messer Knife Fers Cuchillo	Vorschneider Spurs Araseur Placa reversible de macho inicial	Best.-Nr. Order-No. Ref.-No. Réf.-No.	EUR*
100 x 30 x 30	2	4	1 004 030	110,85
100 x 40 x 30	2	4	1 004 040	113,05
100 x 50 x 30	2	4	1 004 050	116,35
125 x 30 x 30	2	4	1 254 030	119,10
125 x 40 x 30	2	4	1 254 040	124,05
125 x 50 x 30	2	4	1 254 050	129,60
125 x 60 x 30	2	4	1 254 060	157,65



125 x 50 x 30	4	4	1 254 450	194,25
---------------	---	---	-----------	--------

Ersatzteile Spare parts pièces de rechange Piezas de recambio	Abmessung Dimension Medidas mm	Stück/Packung Number/pack Pièce/paquet Piezas/paquete	Best.-Nr. Order-No. Ref.-No. Ref.no.	EUR*
HW-Wendeplatten	30x12x1,5	10	0 305 510	2,40
	40x12x1,5	10	0 405 510	3,10
	50x12x1,5	10	0 505 510	3,15
	60x12x1,5	10	0 605 510	3,95
HW-Vorschneider	14x14x2,0	10	0 145 510	1,85
Schlüssel	S4		4 001	1,50
Senkpaßschraube			4 020	1,50

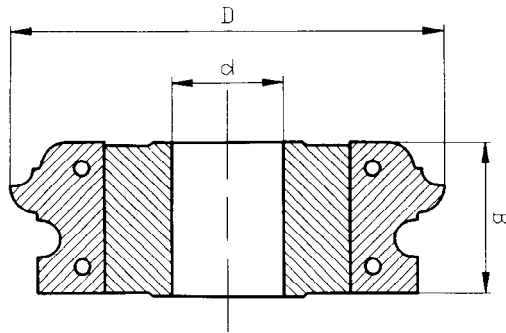
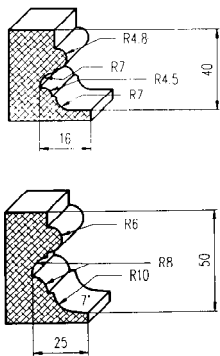

Abmessung Dimension Medidas Ø mm	B	d	Z	Best.-Nr. Order-No. Réf.-No. Ref.no.	EUR*
120	40	30	2	1 205 050	203,95
160	50	30	2	1 605 052	248,05
HW-Profilemesser 1		40 x 25 x 2 mm		1 205 051	39,70
HW-Profilemesser 2		50 x 27 x 2 mm		1 605 053	45,20

Hartmetall-Wendeplatten-Verleimfräser

Glue-joint cutter block
Fraise pour joints collés
Fresa de encolar WPL

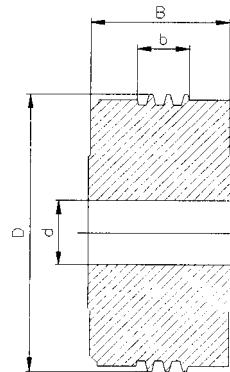
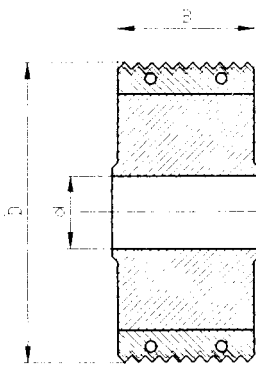

Abmessung Dimension Medidas Ø mm	B	d	Z	Best.-Nr. Order-No. Réf. No. Ref.no.	EUR*
120	50	30	2	1 205 600	176,40
130	50	30	2	1 305 602	302,70
130	60	30	2	1 306 604	317,00
HW-Wendeplatte 50x12x1,5 mm				1 205 601	25,95
HW-Wendeplatte 50x24x2,0 mm				1 305 603	50,70
HW-Wendeplatte 60x24x2,0 mm				1 306 605	54,00

Hartmetall-WPL Schwenkmesserkopf

TCT adjustable chamfering cutter
 Porte-outil à têtes inclinables à plaquettes carbure réversibles
 Portachuchillas regulable WPL

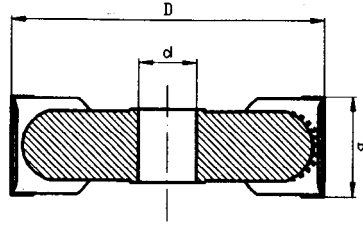
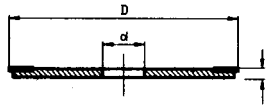

Abmessung Dimension Medidas	Ø mm		Zähnezahl No. teeth Denture Dentado	Verstellwinkel Adjusting angle Angle de réglage Angular posteriore	Best.-Nr. Order-No. Réf.-No. Ref.no.	EUR*
	B	d				
110	40	30	2	0-45° stufenlos	1 105 700	366,60
160	50	30	2	0-90° stufenlos	1 605 702	443,10

HW-Vorschneiderplatte

160	30	V2	1 605 705	135,65
HM-Wendeplatten	40x12x1,5 mm		0 405 510	3,10
HM-Wendeplatten	50x12x1,5 mm		0 505 510	3,20
HM-Vorschneider	14x14x2,0 mm		0 145 510	1,85

Hartmetall-Wechselplatten Konterprofil Fräskopf

TCT counter profile cutter block
 Porte-outil à contre-profil au carbure
 Placas reversibles de metal duro para fresas de contraperfilado

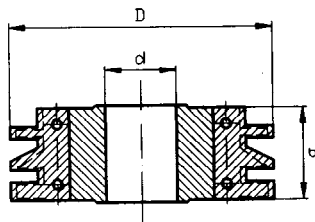
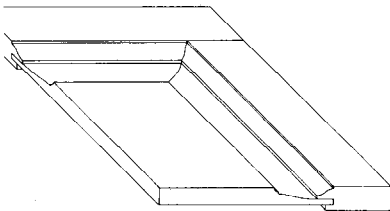

Abmessung Dimension Medidas	Ø mm		Zähnezahl No. teeth Denture Dentado	Best.-Nr. Order-No. Réf.-No. Ref.no.	EUR*
	B	d			
120	40	30	2	1 205 800	230,40
HM-Wechselplatte	40x26x2 mm		Profil 1 - R4	1 205 802	42,50
HM-Wechselplatte	40x26x2 mm		Profil 2 - R5	1 205 804	42,50
HM-Wechselplatte	40x26x2 mm		Profil 3 - R6	1 205 805	42,50
HM-Wechselplatte	40x26x2 mm		Profil 4 - 26,5°	1 205 806	42,50

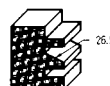
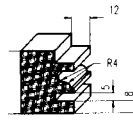

Zweiteilig, durch Zwischenringe verstellbar. Zum Nuten von Holz- und Holzwerkstoffen. Einwandfreie Schnittergebnisse durch Vorschneiderausführung.

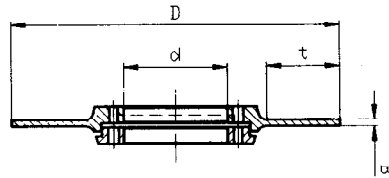
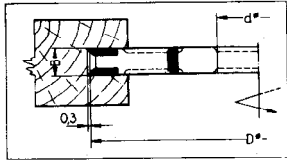

Abmessung Dimension Medidas			Zähnezahl No. teeth Denture Dentado	Nuttiefe max. Grooving depth Profondeur à rainurer Profundidad de freado	Best.-Nr. Order-No. Réf.-No. Ref.no.	EUR*
Ø D mm	B	d				
130	4 - 7,5	30	4 + 4	20	1 305 100	338,50
180	4 - 7,5	30	8 + 4	35	1 805 105	349,50
180	8 - 15	30	4 + 4	35	1 805 106	355,60

Hartmetall-Wendeplatten – Verstellnuter mit Gewindebüchsen

Tungsten panel raising cutterblock – Adjustable grooving cutter on threaded bush
Fraise à plate-bande au carbure – Porte-outil à rainier extensible par manchon fileté
Fresas ranuradoras regulables con casquillo enroscable

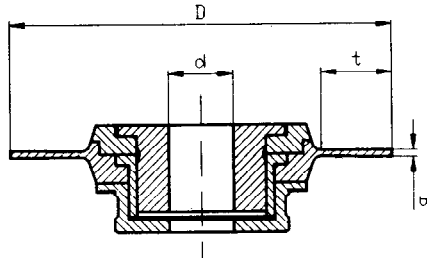
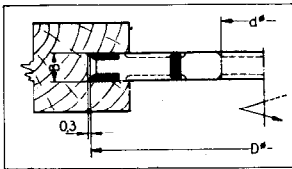



Abmessung mm Dimension Medidas			Zähnezahl No. teeth Denture Dentado	Nuttiefe max. Grooving depth Profondeur à rainurer Profundidad de freado	Best.-Nr. Order-No. Réf.-No. Ref.no.	EUR*
Ø D mm	B	d				
130	4 - 7,5	30	4 + 4	20	1 305 110	504,95
180	4 - 7,5	30	8 + 4	35	1 805 115	528,15
180	8 - 15	30	4 + 4	35	1 805 116	468,60

Ersatzteile Spare parts Pièces de rechange Piezas de recambio	Abmessung Dimension Medidas mm	Stück/Packung Number pack Pièces par paquet Piezas por paquete	Best.-Nr. Order-No. Réf.-No. Ref.no.	EUR*
HW-Räumerzähne	18 x 18 x 1,95	10	1 818 195	8,25
HW-Wendeplatten	7,5x 12 x 1,5	10	0 075 510	3,15
HW-Wendeplatten	12 x 12 x 1,2	10	0 125 510	3,50
HW-Wendeplatten	14 x 14 x 1,2	10	0 146 510	3,15

Hartmetall-WendePlatten-Ablattfräser

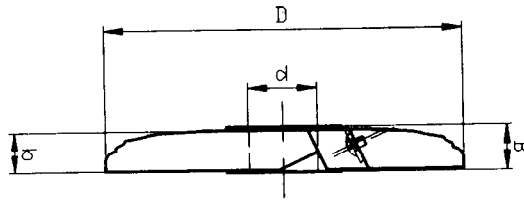
Tungsten panel raising cutter block
 Fraise à plate-bande au carbure
 Fresas de achatar de metal duro WPL



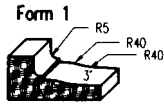
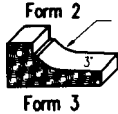

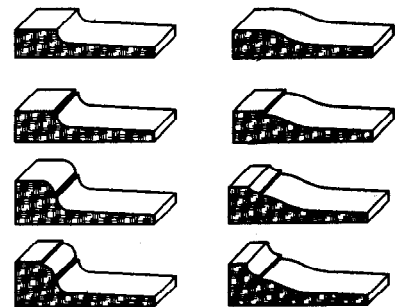
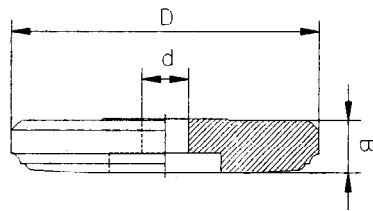

Abmessung Dimension Medidas				Best.-Nr. Order-No. Réf.-No. Ref.no.	EUR*
Ø D mm	B	d	Z		
160	20	30	2	1 605 040	185,85
					
					
					

Hartmetall-WendePlatten-Abplattfräser, 2-teilig

Tungsten panel raising cutterblock, split pattern
 Fraise à plate-bande au carbure, en deux pièces
 Fresas de achatar de metal duro WPL



Abmessung Dimension Medidas				Best.-Nr. Order-No. Réf.-No. Réf. no.	EUR*
Ø D mm	B	d	Z		
200	35	30	2 + 2 gerade, mit Profil 2 + 3	2005 036	308,70
200	35	30	2 + 2 profiliert, mit Profil 1 + 4	2005 038	308,70
					
					
					
					

* Unverb. Preisempfehlung zuzügl. gesetzl. MwSt