

## POLYGLASS PRESSURE VESSELS

2 1/2" TOP POLE-LESS  
2 1/2" TOP POLE-PIECE  
PRODUCT CODES



# STRUCTURAL

TECHNICAL DATA & DRAWINGS

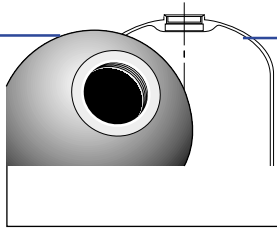

**POLYGLASS  
PRESSURE VESSELS**

**STRUCTURAL**

**TECHNICAL DATA**



This pressure vessel is intended for use in water treatment installations.  
Not suitable for pneumatic applications.

TOP HOLE THREADING :	2 <sup>1/2</sup> " - 8 NPSM
OPERATING PRESSURE :	MIN 0 BAR - MAX 10 BAR
OPERATING TEMPERATURE :	MIN 1°C - MAX 50°C
MINIMUM FATIGUE TESTING :	250.000 CYCLES BETWEEN 0 - 10 BAR
STANDARD COLOUR :	DURALAM BLUE VESSEL, RAL 5015, BLACK BASE
OTHER POSSIBLE COLOURS :	RAL-COLOUR STANDARDS
DISTRIBUTION SYSTEMS :	SEE DISTRIBUTION SYSTEMS CATALOGUE

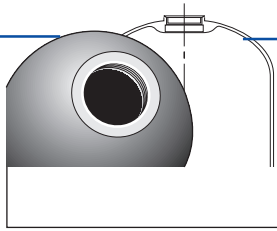

**POLYGLASS  
PRESSURE VESSELS**

DETAIL 2 1/2" THREAD

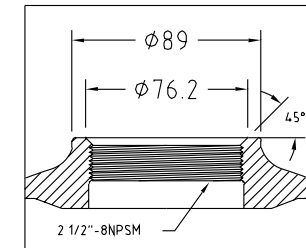

2 1/2" TOP POLE-LESS (1 of 2)

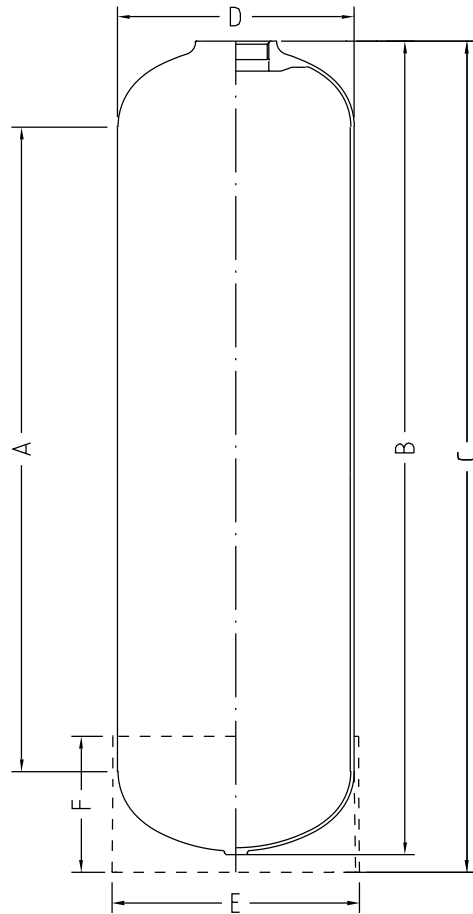

CD-TP-D-175A

TYPE	D (mm)	(l)	(l)	A (mm)	B (mm)	C (mm)	E (mm)	F (mm)	(kg)	(kg)
	External diameter	Volume vessel	Volume dome	Cylindrical height	Height vessel min - max	Total height min - max	Outside diameter base	Height base	Maximum base load	Weight empty vessel
Q-0513-Ax	Ø136	3,4	0,3	233	336-340	336-340	-	-	-	0,9
Q-0521-Ax	Ø136	5,8	0,3	422	523-527	523-527	-	-	-	1,5
Q-0613-Ax	Ø159	4,6	0,6	194	319-323	340-344	Ø170	108	40	1,0
Q-0618-Ax	Ø159	6,9	0,6	327	452-456	473-477	Ø170	108	40	1,2
Q-0621-Ax	Ø159	8,2	0,6	403	528-532	549-553	Ø170	108	40	1,3
Q-0717-Ax	Ø184	8,8	0,9	291	428-432	444-448	Ø195	111	60	1,3
Q-0730-Ax	Ø184	16,8	0,9	623	760-764	776-780	Ø195	111	60	2,1
Q-0735-Ax	Ø184	20,4	0,9	746	883-887	899-903	Ø195	111	60	2,5

x : see product code list

OPERATING PRESSURE : MIN 0 BAR - MAX 10 BAR

OPERATING TEMPERATURE : MIN 1°C - MAX 50°C

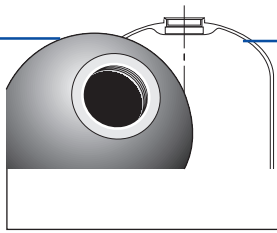

**POLYGLASS  
PRESSURE VESSELS**

DETAIL 2 1/2" THREAD

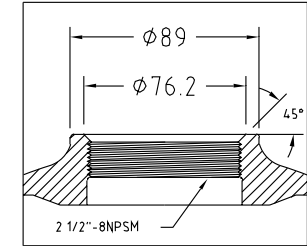

**2 1/2" TOP POLE-LESS (2 of 2)**

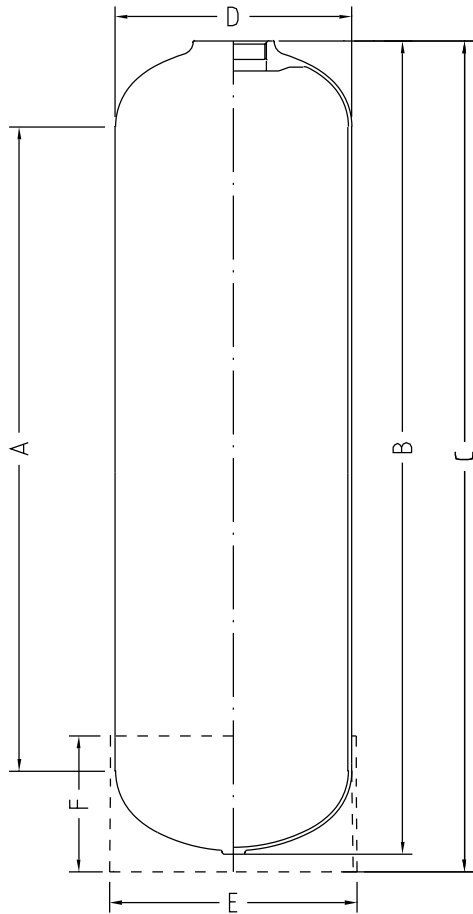

*External diameter*  
*Volume vessel*  
*Volume dome*  
*Cylindrical height*  
*Height vessel min - max*  
*Total height min - max*  
*Outside diameter base*  
*Height base*  
*Maximum base load*  
*Weight empty vessel*

<b>TYPE</b>	<b>D (mm)</b>	<b>(l)</b>	<b>(l)</b>	<b>(mm)</b>	<b>B (mm)</b>	<b>C (mm)</b>	<b>E (mm)</b>	<b>F (mm)</b>	<b>(kg)</b>	<b>(kg)</b>
Q-0817-Ax	Ø208	11,0	1,4	263	416-420	433-437	Ø220	121	75	1,5
Q-0818-Ax	Ø208	11,4	1,4	275	428-432	445-449	Ø220	121	75	1,5
Q-0822-Ax	Ø208	15,4	1,4	403	556-560	572-576	Ø220	121	75	2,1
Q-0835-Ax	Ø208	25,7	1,2	730	883-887	900-904	Ø220	121	75	2,8
Q-0935-Ax	Ø233	31,3	1,9	721	883-887	901-905	Ø247	125	75	3,5
Q-1012-Ax	Ø257	11,5	2,7	133	315-319	334-338	Ø269	148	140	2,1
Q-1013-Ax	Ø257	13,3	2,7	152	334-338	353-358	Ø269	148	140	2,2
Q-1016-Ax	Ø257	16,1	2,7	222	404-408	423-427	Ø269	148	140	2,5
Q-1019-Ax	Ø257	19,1	2,7	299	481-485	500-504	Ø269	148	140	2,0
Q-1023-Ax	Ø257	24,0	2,7	400	582-586	601-605	Ø269	148	140	2,6
Q-1035-Ax	Ø257	38,9	2,7	701	883-887	901-905	Ø269	148	140	4,2
Q-1354-Ax	Ø333	103,1	5,9	1117	1349-1359	1367-1375	Ø330	80	225	3,2

CD-TP-D-177C



x : see product code list

OPERATING PRESSURE : MIN 0 BAR - MAX 10 BAR

OPERATING TEMPERATURE : MIN 1°C - MAX 50°C

**STRUCTURAL**

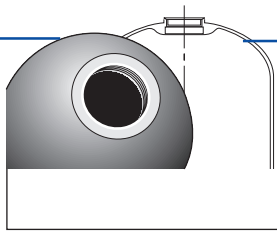

**POLYGLASS  
PRESSURE VESSELS**

DETAIL 2 1/2" THREAD

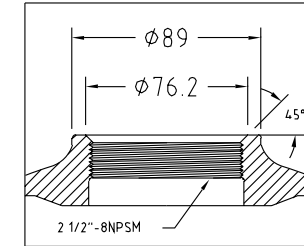

**2 1/2" TOP POLE PIECE**

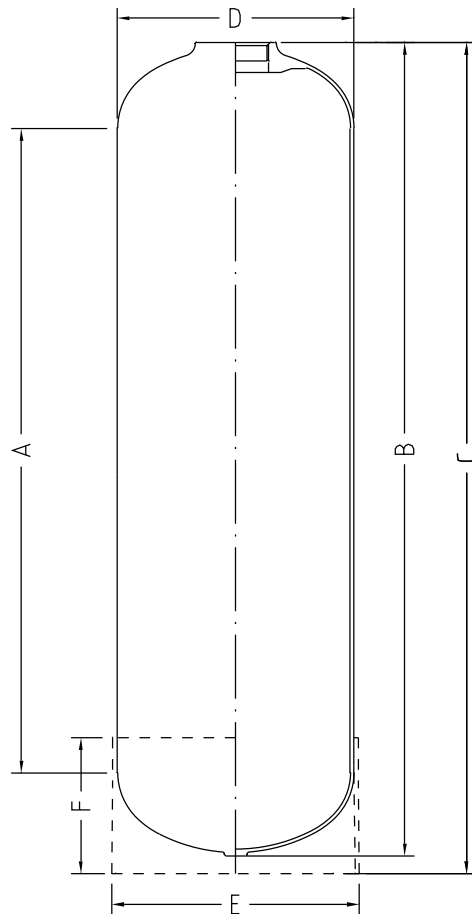

CD-TP-D-176C

	<i>External diameter</i>	<i>Volume vessel</i>	<i>Volume dome</i>	<i>Cylindrical height</i>	<i>Height vessel min - max</i>	<i>Total height min - max</i>	<i>Outside diameter base</i>	<i>Height base</i>	<i>Maximum base load</i>	<i>Weight empty vessel</i>
<b>TYPE</b>	<b>D (mm)</b>	<b>(l)</b>	<b>(l)</b>	<b>A (mm)</b>	<b>B (mm)</b>	<b>C (mm)</b>	<b>E (mm)</b>	<b>F (mm)</b>	<b>(kg)</b>	<b>(kg)</b>
Q-0635-Px	Ø159	14,4	0,6	758	886-890	905-909	Ø170	108	40	2,2
Q-0744-Px	Ø184	25,3	0,9	969	1119-1123	1125-1129	Ø195	111	60	3,2
Q-0840-Px	Ø210	29,9	1,4	845	1010-1014	1016-1020	Ø220	121	75	3,2
Q-0844-Px	Ø210	33,6	1,4	951	1116-1120	1122-1126	Ø220	121	75	3,4
Q-0918-Px	Ø233	14,8	1,9	292	455-459	470-474	Ø247	125	75	2,5
Q-1040-Px	Ø257	43,5	2,7	809	1005-1009	1012-1016	Ø269	148	140	4,6
Q-1044-Px	Ø257	48,0	2,7	917	1113-1117	1120-1124	Ø269	148	140	4,9
Q-1054-Px	Ø257	60,7	2,7	1180	1376-1380	1383-1387	Ø315	148	140	6,2
Q-1248-Px	Ø304	75,6	4,4	992	1215-1221	1229-1235	Ø315	180	170	6,6
Q-1252-Px	Ø304	84,0	4,4	1097	1315-1321	1332-1338	Ø315	180	170	7,8

x : see next page

OPERATING PRESSURE : MIN 0 BAR - MAX 10 BAR

OPERATING TEMPERATURE : MIN 1°C - MAX 50°C

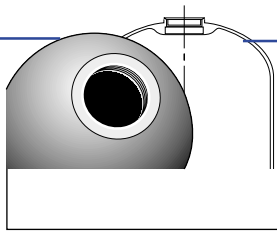

**POLYGLASS  
PRESSURE VESSELS**

**PRODUCT CODES**



	<i>Multiple carton No base</i>	<i>Multiple carton With base</i>	<i>Bulk carton No base</i>	<i>Bulk carton With base</i>		<i>Multiple carton No base</i>	<i>Multiple carton With base</i>	<i>Bulk carton No base</i>	<i>Bulk carton With base</i>
<b>x=</b>	<b>1</b>	<b>3</b>	<b>8</b>	<b>9</b>	<b>x=</b>	<b>1</b>	<b>3</b>	<b>8</b>	<b>9</b>

TYPE	Number of vessels per multiple or bulk carton				TYPE	Number of vessels per multiple or bulk carton			
Q-0513-Ax	-	-	168	-	Q-0840-Px	4	4	25	25
Q-0521-Ax	-	-	92	-	Q-0844-Px	4	4	25	25
Q-0613-Ax	22	22	126	117	Q-0935-Ax	4	4	20	20
Q-0618-Ax	18	18	84	84	Q-1012-Ax	8	8	48	48
Q-0621-Ax	18	18	68	66	Q-1019-Ax	8	8	32	32
Q-0635-Px	9	9	42	42	Q-1023-Ax	8	8	22	22
Q-0717-Ax	18	18	60	60	Q-1035-Ax	4	4	16	16
Q-0730-Ax	9	9	30	30	Q-1040-Px	4	4	16	16
Q-0735-Ax	9	9	30	30	Q-1044-Px	4	4	16	16
Q-0744-Px	9	9	25	25	Q-1054-Px	4	4	16	16
Q-0817-Ax	8	8	50	50	Q-1248-Px	1	1	11	11
Q-0818-Ax	8	8	40	40	Q-1252-Px	1	1	11	11
Q-0822-Ax	8	8	40	40	Q-1354-Ax	1	1	10	10
Q-0835-Ax	4	4	25	25					
Q-0918-P	-	-	30	-					
Q-1013-A	8	8	48	48					
Q-1016-A	8	8	32	32					