

COMPLETE COUPLING (Monobloc)

Electric Motor

| | |
|----------|----------|
| N. Poles | 4 |
| kW | 18,50-22 |
| Hp | 25,16-30 |
| Size | 180 |

Dimensions of Motor

| | |
|-----|-----|
| L | 110 |
| d | 48 |
| Ch | 14 |
| Flg | 350 |

Pump

| | |
|--------------|---------------------|
| Manufacturer | BOSCH REXROTH |
| Model | A10VSO71*/31*-*PA** |

Dimensions of Pump

| | |
|-----|-----|
| L1 | 60 |
| s | 10 |
| d1 | 32 |
| Ch1 | 10 |
| t2 | 0 |
| C | 125 |
| In | 180 |
| Nr | 2 |
| F | M16 |

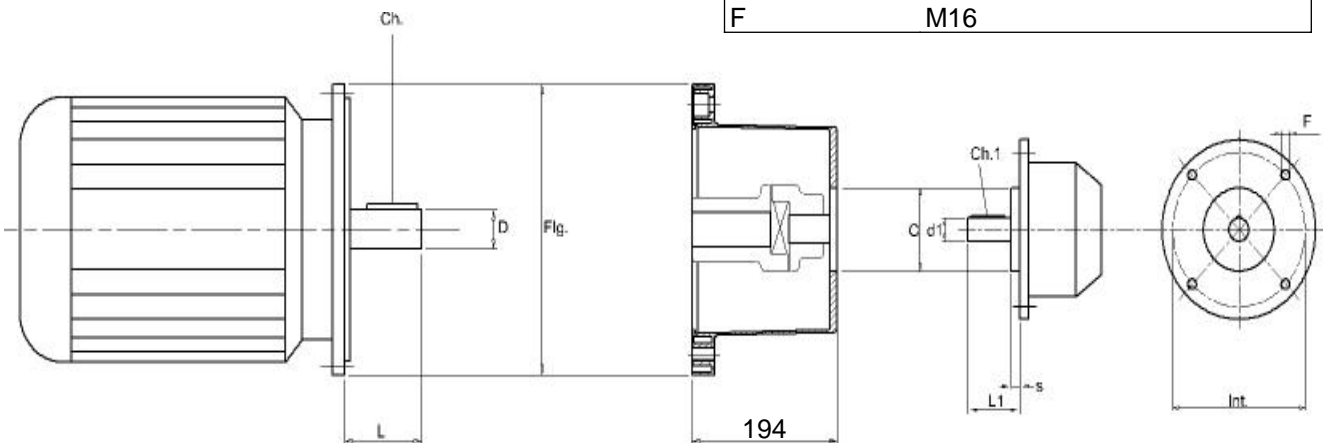

Standard arrangement with black spider - NBR 87 Shore A

PN Bellhousing Kit:

PN Coupling Kit: AKGMM06Z0234CI

PN Complete Kit: AKMM06Z0234CI

Bellhousing Order Code
LMC350AFSU082

Bellhousing Order Code
SGEG40M08110
EGE 4
SGEG40D04045

Max torque
620 Nm
Temperatures °C
-20 : 90

Optional with poliuretano spider red colour - 98 Shore A

RR

PN Bellhousing Kit:

PN Coupling Kit: AKGMM06Z0234CIRR

PN Complete Kit: AKMM06Z0234CIRR

Bellhousing Order Code
LMC350AFSU082

Bellhousing Order Code
SGEG40M08110
EGE 4RR
SGEG40D04045

Max torque
1060 Nm
Temperatures °C
-30 : 180